

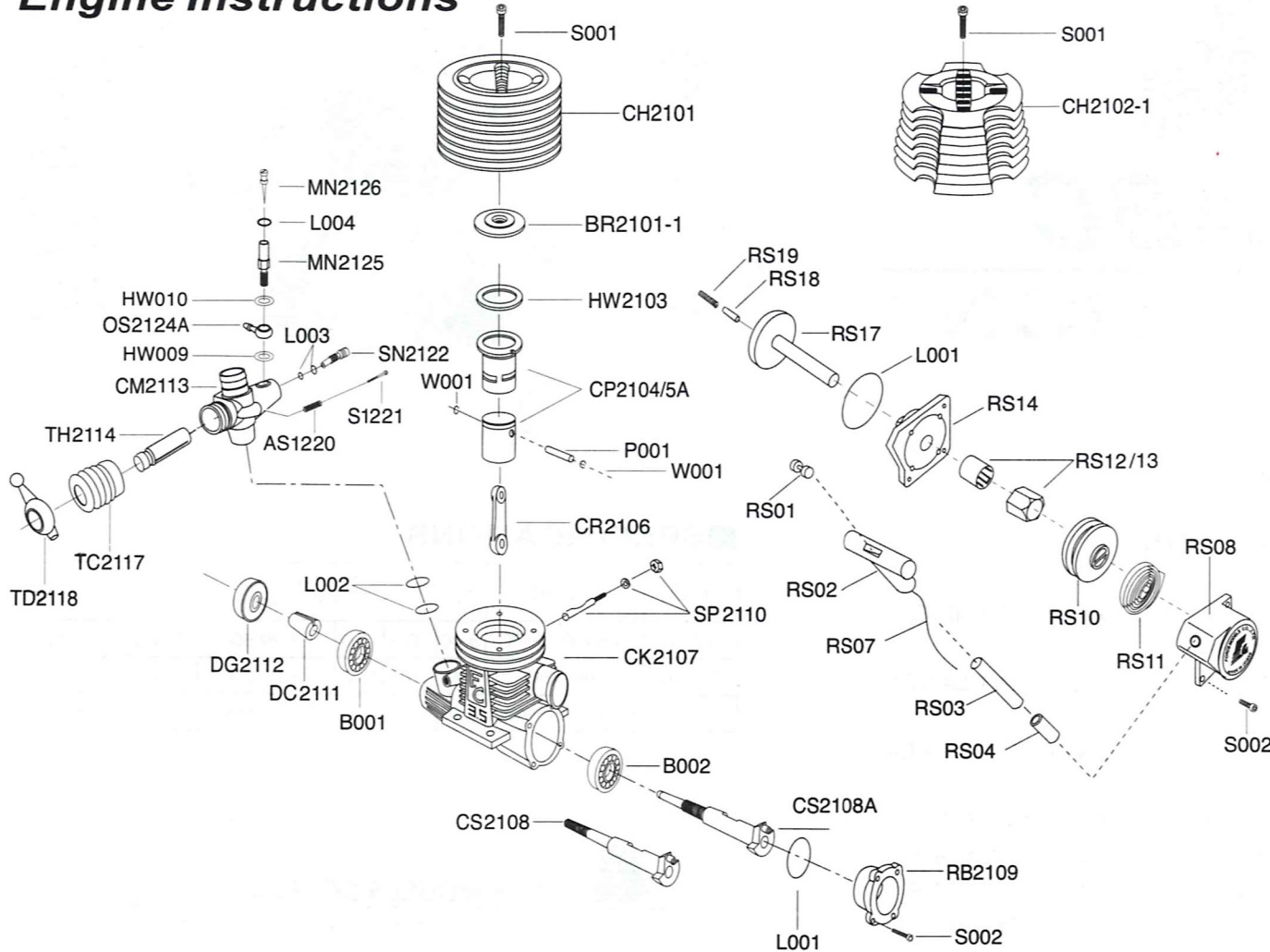

21R /ABC DIVISION PICTURE

Engine Instructions



PARTS LIST

ITEM NO.	DESCRIPTION
AS1220	ADJUSTED SCREW SPRING
BR2101-1	BURN ROOM
B001	BALL BEARING 607Z
B002	BALL BEARING 6901 12×24×6 12MM
CH2101	CYLINDER HEAD (PRO)
CH2102-1	CYLINDER HEAD (CASTING)
CK2107	CRANKCASE
CP2104/5A	CYLINDER SLEEVE / PISTON
CR2106	CONNECTING ROD
CS2108	CRANKSHAFT 12MM
CS2108A	CRANKSHAFT SG 12MM
CM2113	CARBURETOR MAIN BODY
CM2113-1	CARBURETOR COMPLETELY SET
DC2111	DRIVE BRASS WASHER
DG2112	DRIVE GEAR
HW009	WASHER0.6×4.1×7.5MM
HW010	WASHER0.6×5.1×7.5MM
HW2103	CYLINDER HEAD WASHER-0.2MM
L001	REAR COVER "O" RING
L002	CARBURETOR "O" RING
L003	SUPPLY NEEDLE VALVE "O" RING SET
L004	MAIN NEEDLE VALVE "O" RING
MN2125	MAIN NEEDLE VALVE HUB
MN2126	MAIN NEEDLE VALVE
OS2124A	OIL SUPPLY NOZZLE
P001	PISTON GUDGEON PIN
RB2109	REAR BACK COVER
S001	CYLINDER HEAD BOLT (M3×12)
S002	REAR COVER BOLT
S1221	THROTTLE ADJUSTMENT SCREW
SN2122	SUPPLY NEEDLE VALVE
SP2110	CARBURETOR SETTING PIN AND NUT
TC2117	THROTTLE COVER
TD2118	THROTTLE SCREW CAP
TH2114	THROTTLE & COUNTER NEEDLE VALVE
W001	"G" PIN SNAP RING
A PARTS ASSEMBLY DIAGRAM	
A PARTS ASSEMBLY FOR PULL START ENGINE	
RS01	STRING SEAT
RS02	HANDLE
RS03	BUFFER HEAD WASHER
RS04	BUFFER HEAD WASHER SEAT
RS07	STARTING STRING
RS08	REAR COVER
RS10	THREAD SEAT
RS11	EDDY SPRING
S002	REAR COVER WASHER (M2.6*6)
B PARTS ASSEMBLY DIAGRAM	
B PARTS ASSEMBLY FOR 21 REAR ENGINES	
B21	B PARTS ASSEMBLY FOR 21 REAR ENGINES
L001	REAR COVER "O" RING
RS12/13	ONE WAY BEARING SET
RS14	CONNECTIVE SEAT
RS17	STARTING AXLE
RS18	STARTING PIN
RS19	PRESSURE SPRING
S002	REAR COVER SCREW M2.6*6 4PCS