



## Chassis Conversion Kit Installation Instructions

### Kit contents:

- Rear upper suspension link (assembled with angled rod ends and hollow balls) (2)
- Rear lower suspension link (assembled with standard rod ends and hollow balls) (2)
- Front shock towers (left and right)
- Rear shock towers (left and right)
- Long female half shaft

### Tools required:

- 2.0mm hex wrench
- 1.5mm hex wrench

Retain and reuse all parts except where indicated **X**

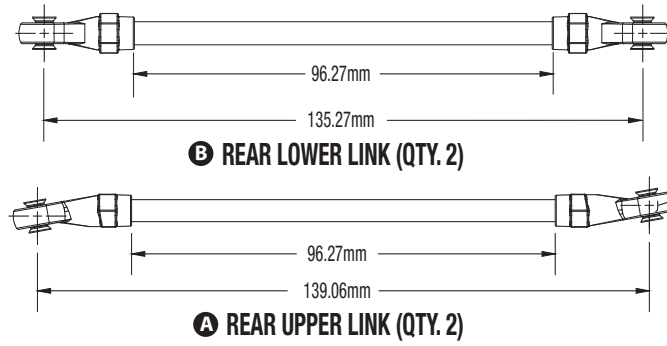

### Rear Center Driveshaft Assembly

#### Align Phasing Marks

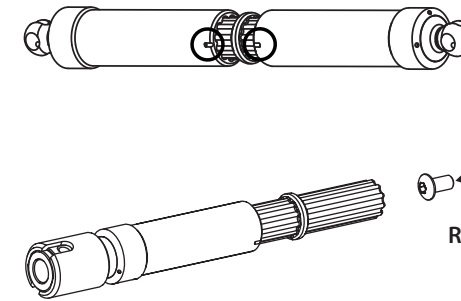

### Driveshaft Length Indicators

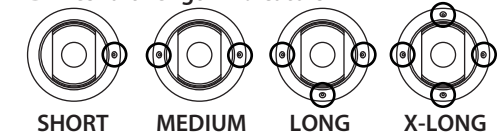

Covers Parts #8057

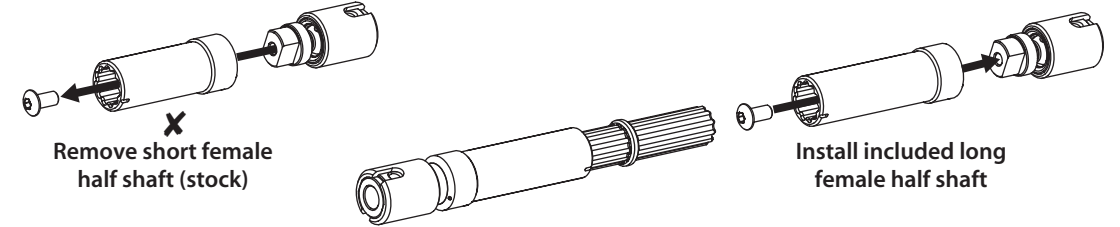

### 1. Remove chassis-mounted inner fenders

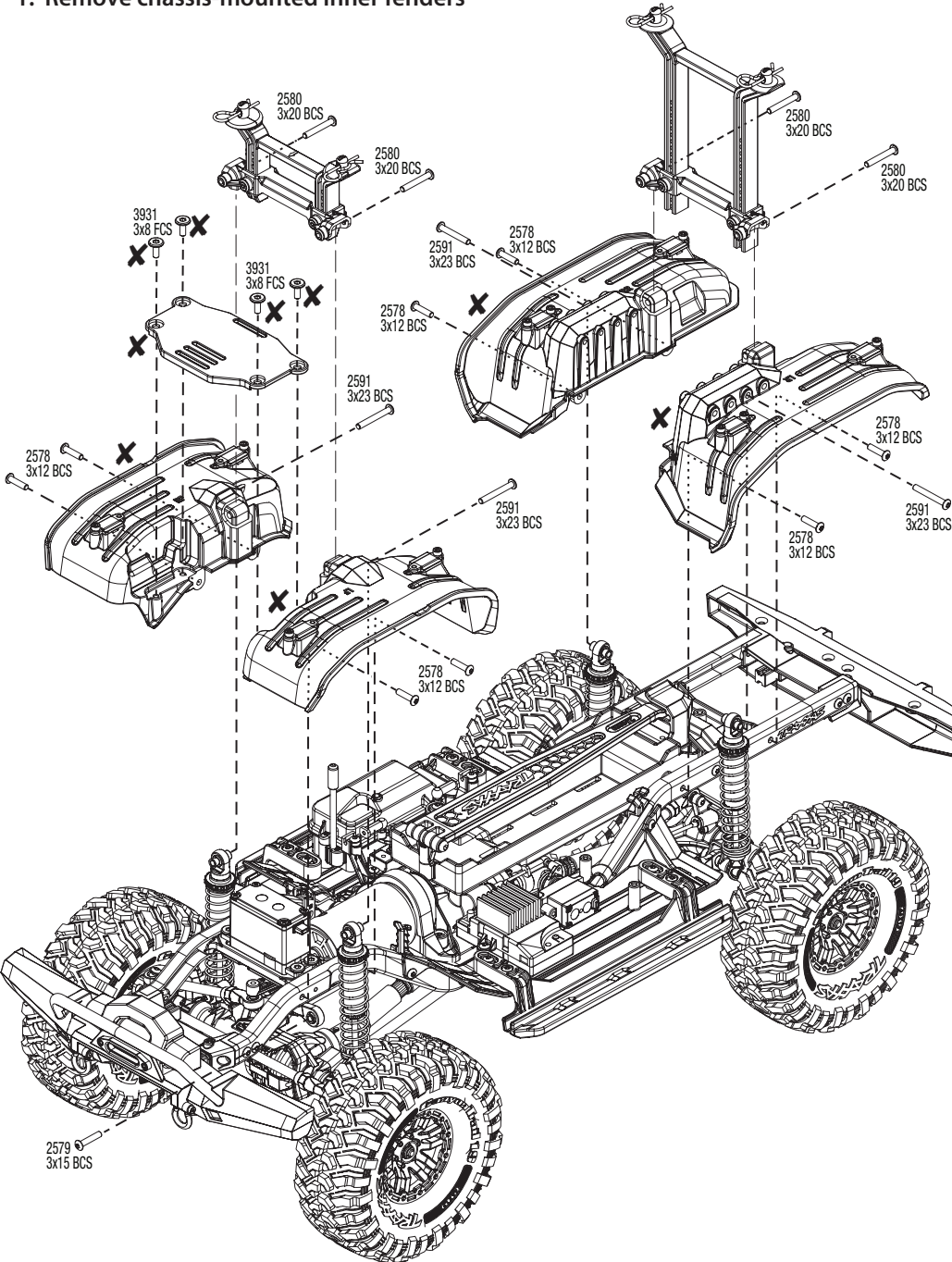

### 2. Install front and rear shock towers

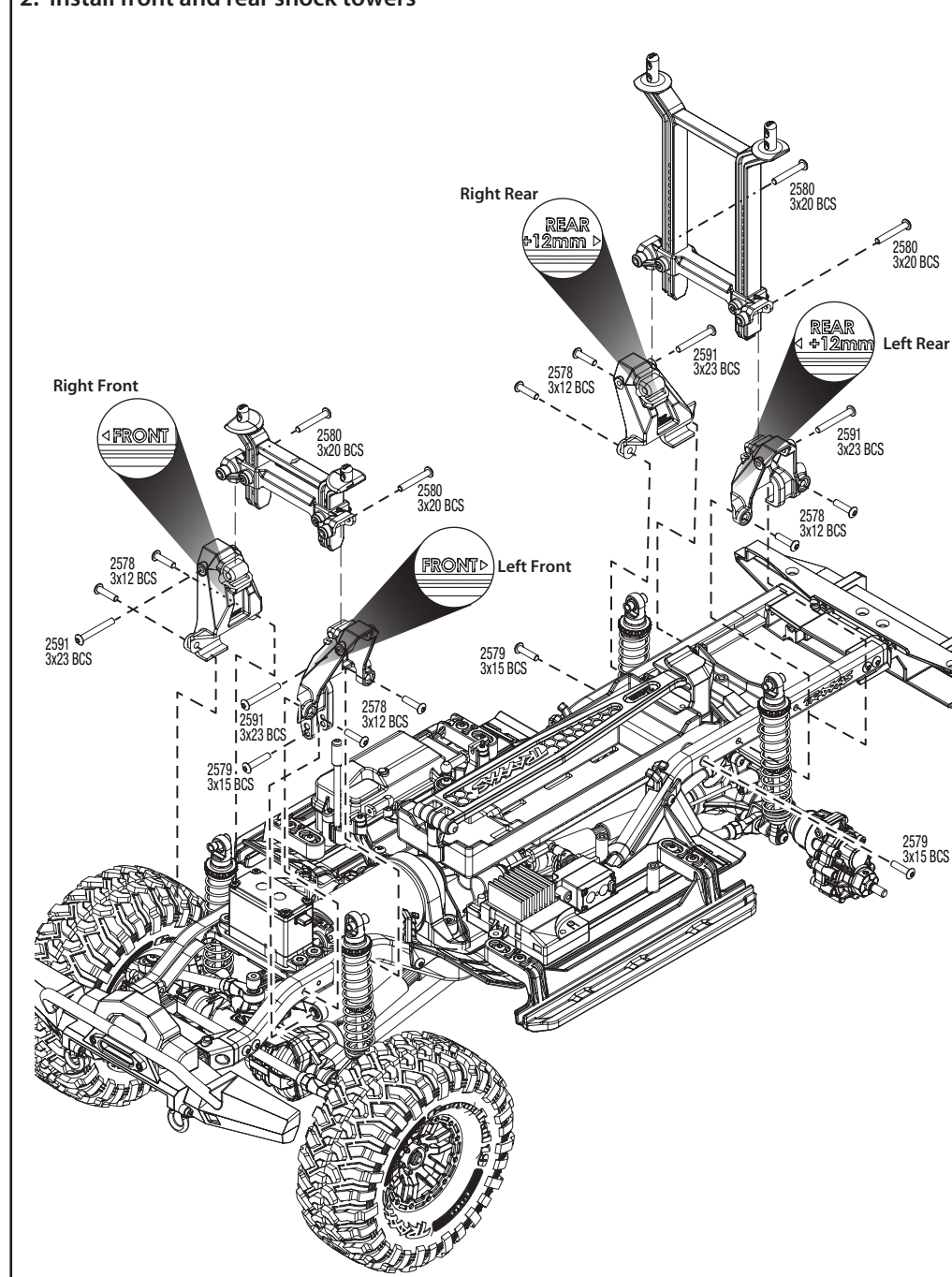

### 3. Remove rear center driveshaft and rear suspension links; install new driveshaft and rear suspension links

